



## St John's Crescent, Brixton, SW9

3 bedroom flat - conversion for sale

**£520,000**

Leasehold

### Property Details

A beautifully proportioned three bedroom Victorian conversion, set within an attractive double-fronted detached residence on the sought-after St John's Crescent, overlooking the park opposite. Occupying an elevated second-floor position, the property enjoys a wonderfully bright and private ambience, recently refreshed throughout with neutral décor and warmly toned flooring, creating a blank canvas ready to move into. The spacious reception spans over four metres in width, centred around a large sash window framing uninterrupted park views. Adjacent, the separate kitchen diner offers shaker-style cabinetry, ample dining space and potential to add an island if desired. The generous principal bedroom is quietly positioned to the rear, separate from the remaining rooms. The second bedroom is a genuine double with park views, whilst the versatile third bedroom also overlooks the greenery. A well-positioned bathroom completes the accommodation, fitted with a bathtub and overhead shower.

### Features

- Three bedrooms
- Detached Victorian conversion
- Kerb appeal
- Overlooking the park
- Recently refreshed
- Bright and airy
- Central Brixton a four-minute stroll
- Brixton Tube a seven-minute walk
- Stockwell and Clapham nearby
- Chain-free

Council tax band D    EPC rating C (71)





St John's Crescent, Brixton, SW9

**St John's Crescent, SW9**  
**3 Bedroom Flat**

APPROXIMATE GROSS INTERNAL AREA: 793 SQ FT / 73.6 SQ M

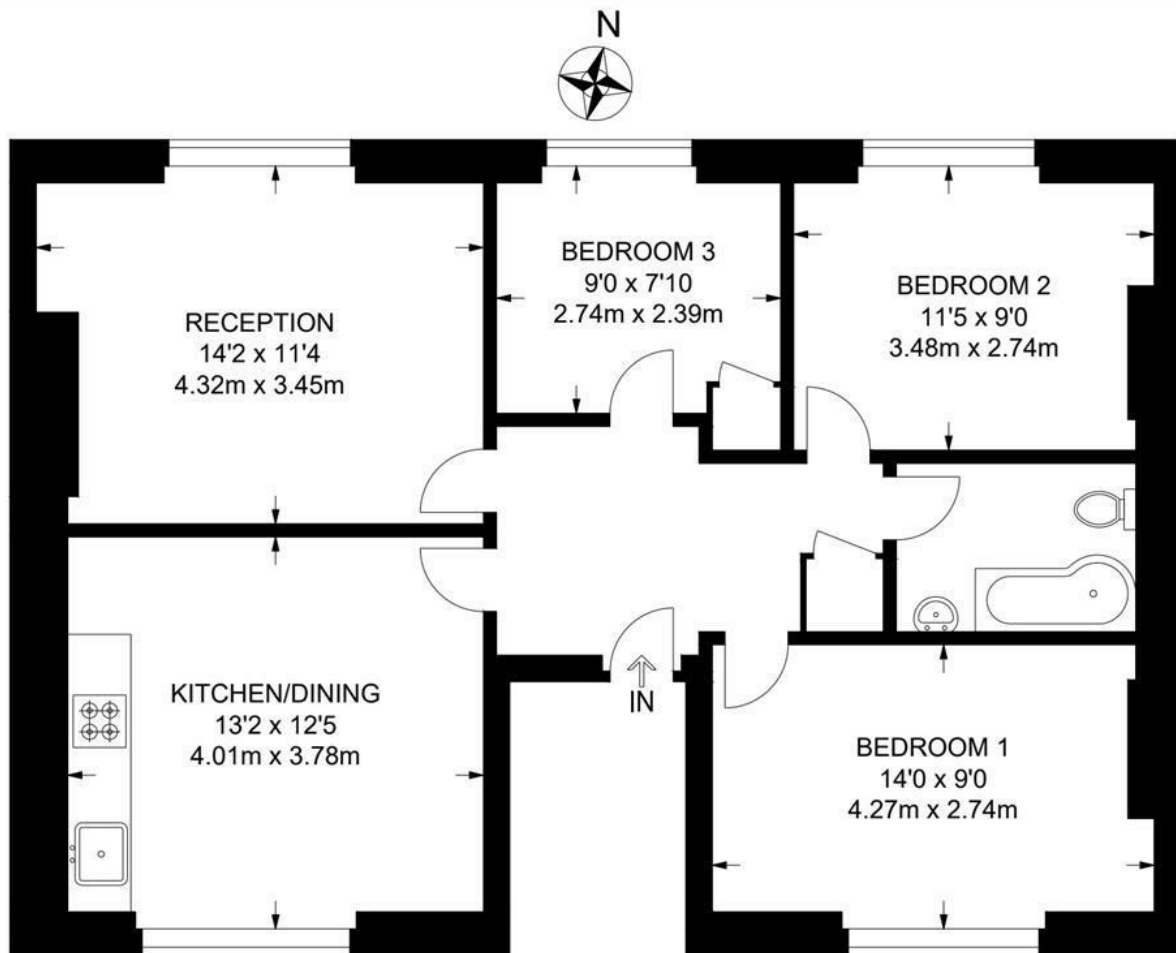

**SECOND FLOOR**



While we try our very best, floor plans are produced as a guide only and we take no responsibility for the precise accuracy with which any property is represented.

St John's Crescent, Brixton, SW9

